

- LEGEND**
- TEMPORARY CONTROL POINT
  - EXISTING CONTOUR
  - UNDERGROUND OUTLET
  - EXISTING CONCRETE
  - SWALE/DITCH FLOW LINE

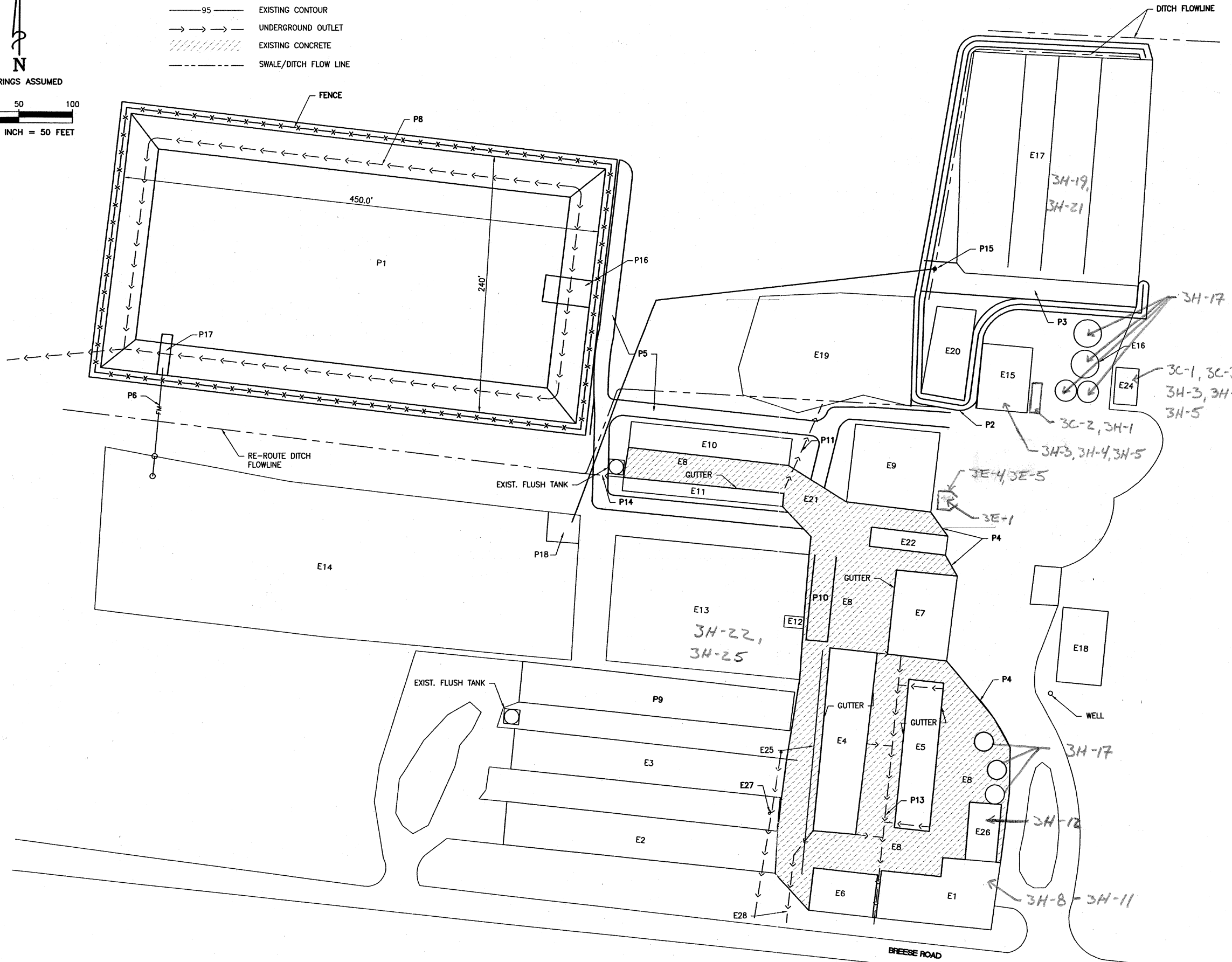

EXISTING FACILITY DETAILS	
ITEM	FACILITY DESCRIPTION
E1	PARLOR
E2	FREESTALL BARN
E3	FREESTALL BARN
E4	FREESTALL BARN
E5	COVERED FEED BUNK
E6	COVERED CONCRETE MANURE PIT
E7	POST FRESH BEDPACK BARN
E8	FEEDLOT AREA
E9	LEAN-TO-BEDPACK AREA
E10	BEDPACK HEIFER BARN
E11	COVERED FEED BUNK
E12	CONC. MANURE PUSH OFF RAMP
E13	SOLIDS SETTLING POND
E14	HOLDING POND
E15	MACHINE SHED
E16	GRAIN BINS
E17	SILAGE BUNKER
E18	OPERATOR RESIDENCE
E19	HOLDING POND
E20	CALF HUT AREA
E21	CURBED CONC. SCRAPE ALLEY
E22	COVERED FEED BUNK
E23	SILOS
E24	MACHINE SHED
E25	CONC. MANURE TRANSFER CHANNEL
E26	COMMODITY SHED
E27	UNDERGROUND OUTLET PIPE
E28	UNDERGROUND OUTLET PIPE

PROPOSED FACILITY DETAILS	
ITEM	FACILITY DESCRIPTION
P1	EARTHEN HOLDING POND
P2	EARTHEN DIVERSION BERM/SWALE
P3	CONCRETE WASTE TRANSFER PAD
P4	MOUNTABLE CONC. CURB
P5	ACCESS ROAD
P6	ON-SITE PUMP/FORCEMAIN
P8	SUBSURFACE DRAIN TILE
P9	FREESTALL BARN
P10	MODIFIED MANURE STACKING/STAGING AREA
P11	UNDERGROUND ROOF OUTLET PIPE
P13	UNDERGROUND ROOF OUTLET PIPE
P14	UNDERGROUND ROOF OUTLET PIPE
P15	RECEPTION BOX W/GRAVITY PIPING SYSTEM
P16	CONC. PUMPING/AGITATION PAD
P17	CONC. INFLUENT PAD
P18	CONC. INFLUENT PAD

REVISIONS

7615 NORTH HARPER DRIVE  
P.O. BOX 1015  
PERRIS, CA 92407  
TEL (951) 947-7615  
FAX (951) 947-7616

**MAURER & STUTZ, INC.**  
ENGINEERS SURVEYORS  
"WORKING WITH YOU BY DESIGN"

1670 EAST 10TH STREET  
P.O. BOX 1015  
PERRIS, CA 92407  
TEL (951) 947-7615  
FAX (951) 947-7616

FARMSTEAD CONCEPT PLAN

DAIRY CNMP

Client: CD&R FARMS, INC.

Designed By: JEO/AKO  
Drawn By: JEA  
Reviewed By: TLF  
Date: APRIL 23, 2010  
Project No.: 238-10001.01  
Sheet No.:

S:\238\2010 project\23810001.01\CD&R Farmstead\CD&R Farmstead.dwg 4/23/2010 4:57 PM

SCALE VALID ONLY ON 22"x34" SIZE PLANS

THE IDEAS, DESIGNS, AND DRAWINGS REPRESENTED HERE ARE THE SOLE PROPERTY OF MAURER STUTZ INC. REPRODUCTION OR USE IN WHOLE OR PART, FOR ANY OTHER PROJECT WITHOUT AUTHORIZATION FROM MAURER STUTZ INC. IS PROHIBITED. COPYRIGHT 2009 MAURER STUTZ INC. PROFESSIONAL DESIGN FIRM LICENSE #184-005754 PROFESSIONAL ENGINEER LICENSE #062-052169 RENO NV. 11-30-11

THE CONTRACTOR/BUILDER SHALL VERIFY ALL DIMENSIONS AND REPORT ANY DISCREPANCIES TO THE DESIGNER IMMEDIATELY.