

## **Site Information**

### **Site Description**

The North Fork Pork facility and fields are located in St. Albans Township (Section 8) of Hancock County. The facility consists of two breeding/gestation barns (721' x 77'; 2900 sows each), farrowing house (772' x 81'; 1008 sows & litters, and 670 nursery pigs), and gilt developer (236' x 81'; 1280 gilts). Both breeding/gestation barns drain to 10' deep pits, the farrowing house has a 2' pull plug system that drains to the gestation barn pits. The gilt developer has its own 8' deep pit. The gestation pits have a capacity of 545,000 ft<sup>3</sup> each (8,153,200 gal), for a combined storage period of 599 days. The gilt developer pit has a capacity of 150,000 ft<sup>3</sup> (1,122,000 gal) for a storage period of 695 days.

All manure storage facilities are pumped down each fall, and in the spring, if necessary. Manure from the pits is applied using a drag hose system.

Mortality is managed using a composting facility. Composting operation and management is located in section 10 of this CNMP

Approximately 1,146 acres in corn-soybean or corn-soybean-wheat rotation are available for waste utilization. Soil test values for Phosphorus and Potassium are included with the individual basic field information. Recommended manure application rates are found in the Summary Table (section 4), and comply with all provisions of NRCS IL 590 Standard.

See site facility layout on the following page. The farmstead itself is located in Section 8 of St. Albans Township in Hancock County

## Site Soils and Geologic Information

**Table A-1**

Soil Type	Soil Name	Permeability (in/hr)	High Water Table
17A, B2	Keomah silt loam	0.6-2.0	2'-4'
257A, B2	Clarksdale silt loam	0.6-2.0	1'-3'
279B, C2	Rozetta silt loam	0.6-2.0	4'-6'
386B	Downs silt loam	2.0-6.0	4'-6'
43A	Ipava silt loam	0.6-2.0	1'-3'
46A	Herrick silt loam	0.6-2.0	1.5'-3'
50	Virden silty clay loam	0.6-2.0	" +0.5'-2'
6C2	Fishhook silt loam	0.6-2.0	1.5'-3'
119C2	Elco silt loam	0.6-2.0	2.5'-4.5'
971D3	Fishhook-Atlas complex	0.6-2.0	1.5'-3' / 1'-2'
470C2	Keller silt loam	0.6-2.0	1.5'-3'

*Note: Information Obtained from USDA NRCS Hancock Co. Soil Survey*

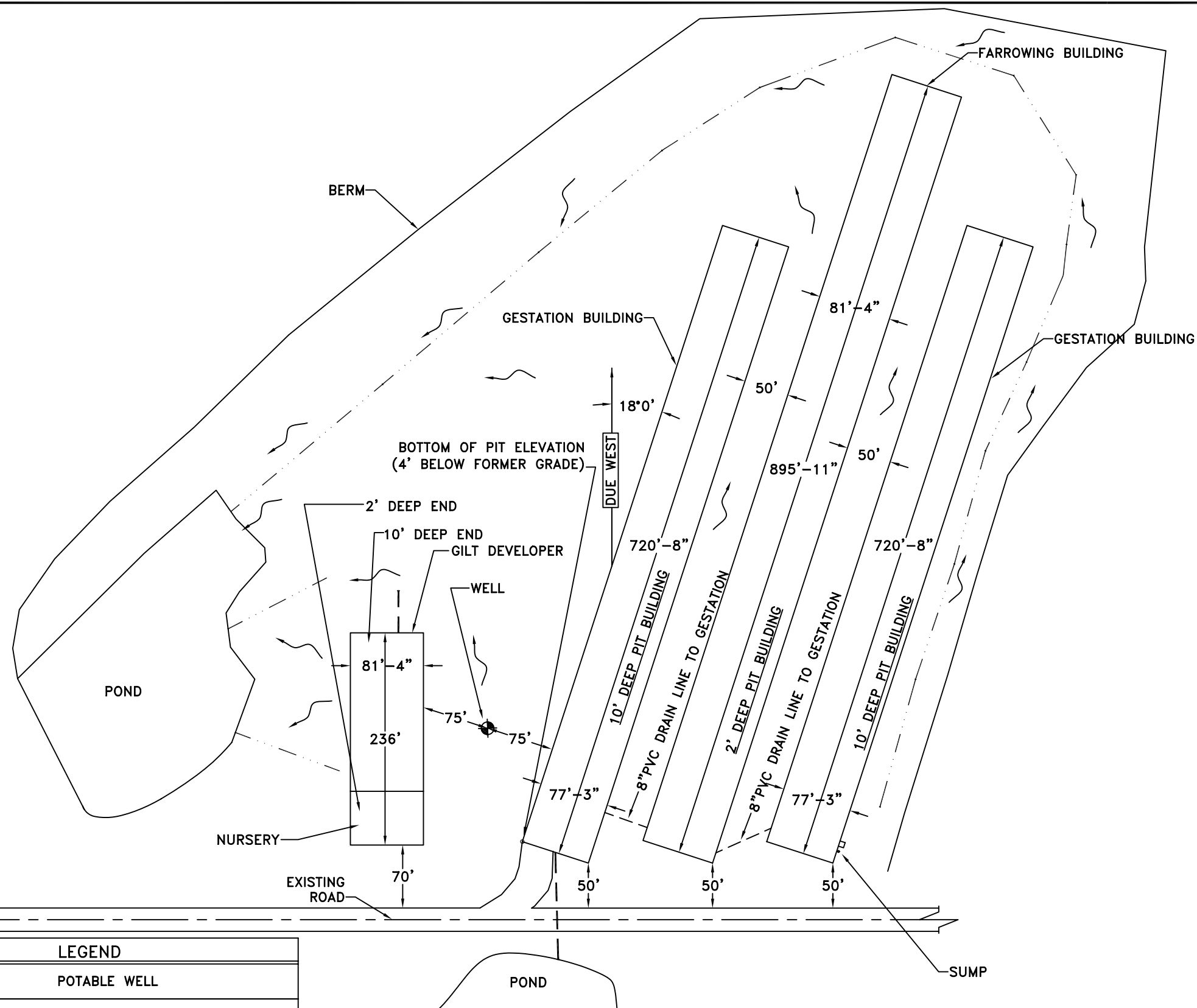
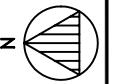

LEGEND	
	POTABLE WELL
	FOUNDATION DRAIN