

## **Site Information**

### **A. Site Description**

Rancho Cantera, LLC. operates a 1400 head dairy in Stephenson County Illinois.

The dairy consists of a 500 head freestall building that measures 423' x 111', a 600 head proposed freestall building that measures 480' x 116' and a 400 head freestall building that measures 400' x 116'. All animal housing structures can be seen on the plot plan on the following page. In addition to the freestall buildings the facility has an existing earthen storage that measures 181' x 743' and 456' x 257'. All waste from the facility is to be flushed to the earthen storage.

The facility also has a separate silage and commodity pad. All stormwater drainage from the pad is directed into the earthen storage as well.

Approximately 1,290 acres are available for manure application. The application acres are in a continuous corn rotation. Preference for manure is to apply in the fall for next years corn crop. Fields are fall chisel plowed, spring field cultivated, and planted. Soil test values for Phosphorus and Potassium are included with the individual basic field information. Risk assessments for Phosphorus and Nitrogen are included in section 16. Recommended manure application rates are found in the Summary Table (section 19), and comply with all provisions of NRCS IL 590 Standard.

In addition to the acres in which the facility owns and applies waste on, the producer markets a large amount of the waste from the facility for fertilizer value. The producer has secured neighboring farmers who which to transfer manure for nutrient application.

Mortalities are handled by a rendering service.

Site soil and geological information is located on the following page.

The Facility itself is located in the NW ¼ of the NE ¼ of section 15, Township 27 North Range 5-East of the 4<sup>th</sup> P.M. in Stephenson County Illinois.

<b>Table A-1 Site Soils and Geologic Information</b>			
Soil Type	Soil Name	Hydric Soils Class	High Water Table
61A	Atterberry silt loam, 0-2% slopes	B	0.5-2.0 ft.
279B	Rozetta silt loam, 2-5% slopes	B	4.0->6.0 ft.
280B	Fayette silt loam, 2-5% slopes	B	--
280C2	Fayette silt loam, 5-10% slopes, eroded	B	--
429C2	Palsgrove silt loam, 5-10% slopes, eroded	B	--
675B	Greenbush silt loam , 2-5% slopes	B	4.0->6.0 ft.
675C	Greenbush silt loam, 5-10% slopes	B	4.0->6.0 ft.
735D2	Casco-Rodman-Fox Complex, 6-12% slopes, eroded	B	--
8074A	Radford silt loam, 0-2% slopes, occasionally flooded	B	1.0-2.0 ft.
8451A	Lawson silt loam, 0-2% slopes, occasionally flooded	C	1.0-2.0 ft.

*Note: Information Obtained from USDA NRCS Stephenson County EFOTG*

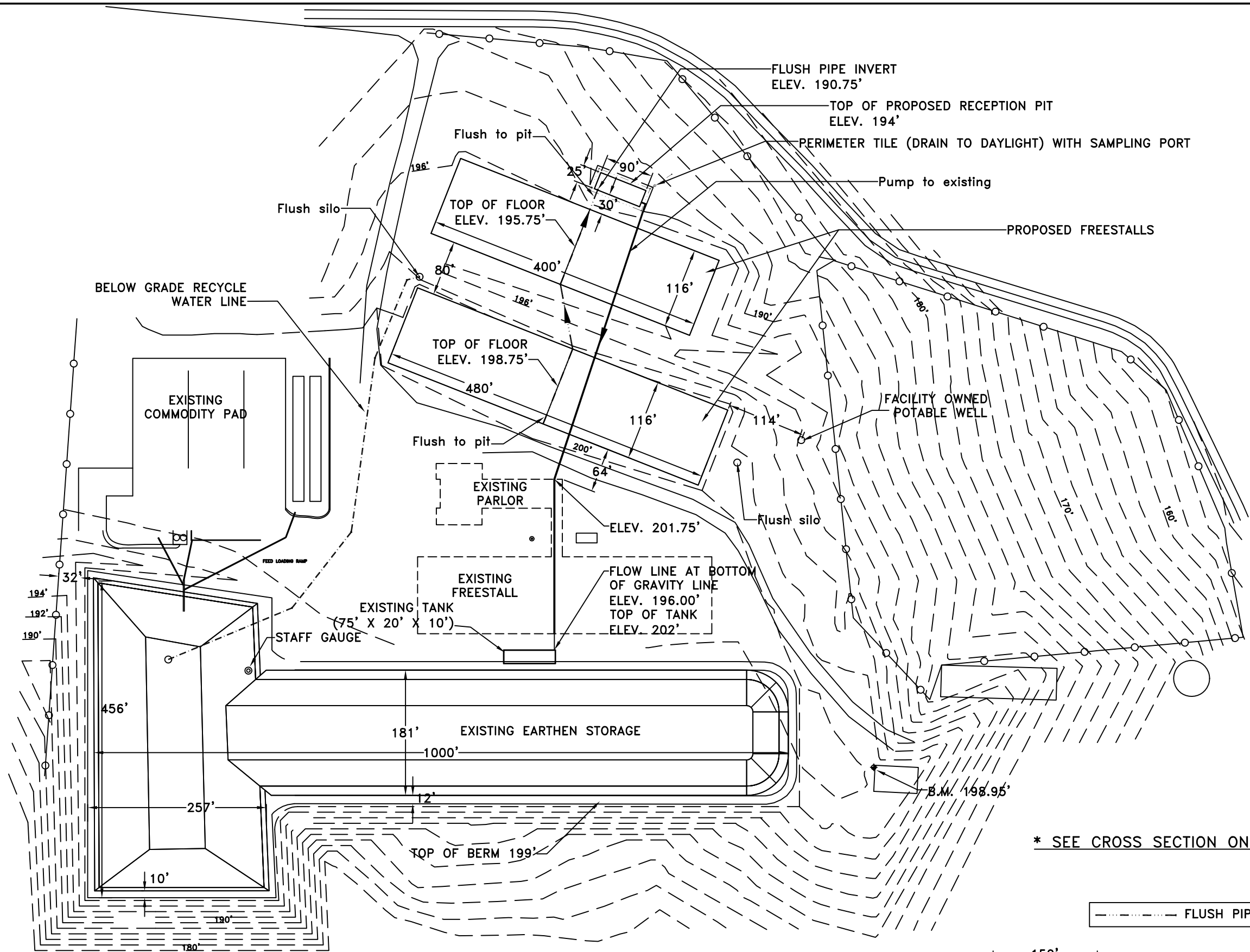
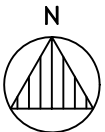

\* SEE CROSS SECTION ON 07-15321

----- FLUSH PIPE

150'

**Frank & West**  
Environmental Engineers, Inc.

RANCHO CANTERA, LLC.

2010 © FRANK & WEST ENVIRONMENTAL ENGINEERS, INC.  
THESE PLANS AND SPECIFICATIONS ARE THE PROPERTY OF  
FRANK & WEST ENVIRONMENTAL ENGINEERS, INC., ARE ONLY  
FOR THIS PROJECT AND MAY NOT BE USED, COPIED OR  
DUPLICATED WITHOUT PRIOR WRITTEN CONSENT.

7226 N. State Route 29  
Springfield, IL 62707  
Phone: 217/487-7686  
Fax: 217/487-7687

PLOT PLAN

DRAWN BY: CEO

SCALE: AS SHOWN | DATE: 09/13/10 | REVISED ON: 12/03/10 | DRAWING NO. 07-15327