

# **Rancho Cantera LLC**

## **Storm Water Management Plan**

### **Site Location**

The facility is located in sections 15 of Township 27-North Range 5-East of the 4<sup>th</sup> P.M. in Stephenson County Illinois. This is approximately a 3.5 acre site consisting of one cattle building, a cattle feeding area, and an open lot. This facility is located in a rural agricultural area where row crops are grown. Yellow Creek lies approximately 500 feet East of the facility perimeter. Attachment A is a facility map, which illustrates the layout of this site.

### **Storm Water Management**

All storm water is directed away from the facility buildings and facilities. The finished man-made and surrounding natural topography allows all surface water to flow away from the facility in a southerly direction. The buildings were built on a relatively level portion of land. The surrounding topography and the gravel allow the storm water to disperse away from individual buildings and the site. The excess storm water leaving the site will run through heavily vegetated areas and eventually drain towards Yellow Creek.

### **Facility Access**

The facility is accessible through one private gravel drive. Only facility employees, feed/animal transportation vehicles or facility service personnel are permitted at the facility for reasons of bio-security. All animal transportation vehicles are required to enter the site clean and free of animal waste or other debris. No vehicles entering the site will be permitted to clean, wash, or empty excess materials onto the ground of the site.

### **Facility Commodity Management**

The products utilized at the facility consist of feed for facility livestock. Feed is transferred directly from the transportation vehicle to storage areas. Spilled feed will be picked up regularly.

### **Facility Mortality Management**

On the rare occasion in which mortalities occur the facility uses a rendering service to handle mortality disposal.

### **Litter Management**

A proper number of dumpsters will be provided on site to handle debris and litter associated with the facility. The litter will be disposed of in an appropriate and timely manner.

### **Hazardous Waste**

There is no and will be no hazardous waste generated at this site.

### **Maintenance/Inspection Procedures**

Facility roads, commodity storage areas, etc., will be inspected at least once a month. A maintenance inspection report will be recorded following each inspection. A copy of the inspection form is provided as Attachment B.

## **Storm Water Best Management Practices**

### Grounds:

- Maintain sufficient surface drainage away from buildings.
- Permanent vegetation will be maintained across the facility.
- Divert rain water away from areas where it could pond.
- Maintain proper gravel cover and landscape gradient so that water does not stand in access roads and around the production facility.
- Remove any spilled feed promptly.

ATTACHMENT A  
FACILITY PLOT PLAN

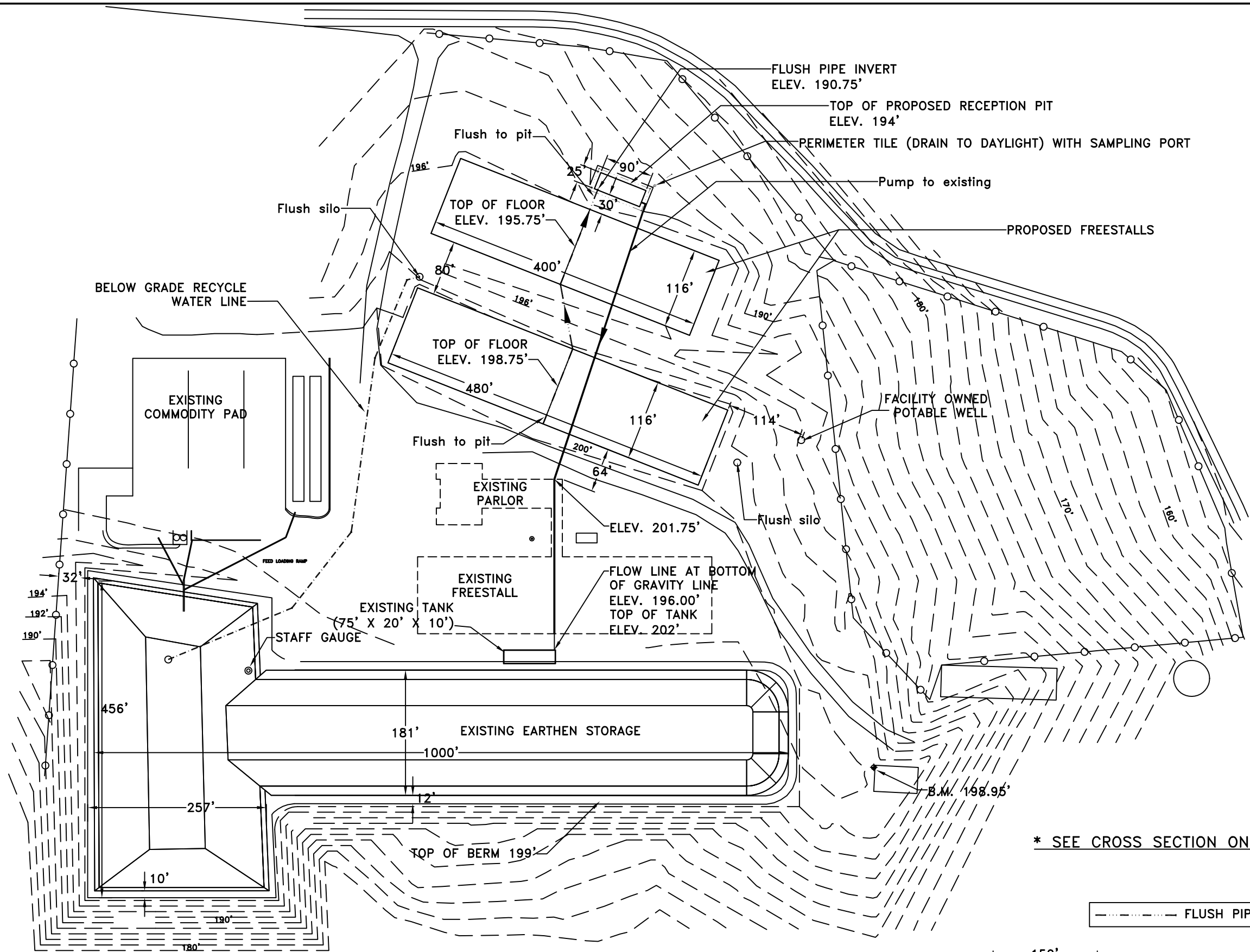
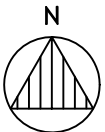

\* SEE CROSS SECTION ON 07-15321

----- FLUSH PIPE

150'

**Frank & West**  
Environmental Engineers, Inc.  
7226 N. State Route 29  
Springfield, IL 62707  
Phone: 217/487-7686  
Fax: 217/487-7687

RANCHO CANTERA, LLC.  
PLOT PLAN  
DRAWN BY: CEO

2010 © FRANK & WEST ENVIRONMENTAL ENGINEERS, INC.  
THESE PLANS AND SPECIFICATIONS ARE THE PROPERTY OF  
FRANK & WEST ENVIRONMENTAL ENGINEERS, INC., ARE ONLY  
FOR THIS PROJECT AND MAY NOT BE USED, COPIED OR  
DUPLICATED WITHOUT PRIOR WRITTEN CONSENT.

SCALE: AS SHOWN DATE: 09/13/10 REVISED ON: 12/03/10 DRAWING NO. 07-15327

**ATTACHMENT B**  
**INSPECTION FORM**

Rancho Cantera, LLC  
 Stormwater Management Plan  
 Inspection Report Form  
 To Be Complete Every Month

Inspector: \_\_\_\_\_ Date: \_\_\_\_\_

Inspector's Qualifications: \_\_\_\_\_

Days Since Last Rainfall: \_\_\_\_\_ Amount of Last Rainfall: \_\_\_\_\_

Area	Date of Last Inspection	Date of Next Inspection	Stabilized	Yes/No	Condition of Vegetation	Visible Erosion
Facility Structures						
Access Drive/Areas						
Vegetated Areas						
Materials Handling Areas (not livestock waste)						
Refuse Sites						
Mortality Areas						
Materials Handling Equipment Storage Areas						
Shipping/Receiving Areas						

Comments: \_\_\_\_\_  
 \_\_\_\_\_

Action(s) Required: \_\_\_\_\_  
 \_\_\_\_\_

To Be Performed By: \_\_\_\_\_ On or Before: \_\_\_\_\_