

Soils Map

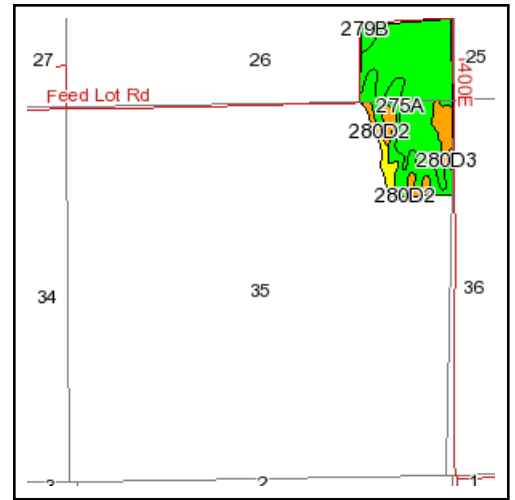

State: **Illinois**
 County: **Henderson**
 Location: **035-010N-005W**
 Township: **Gladstone**
 Acres: **63.9**
 Date: **9/13/2010**

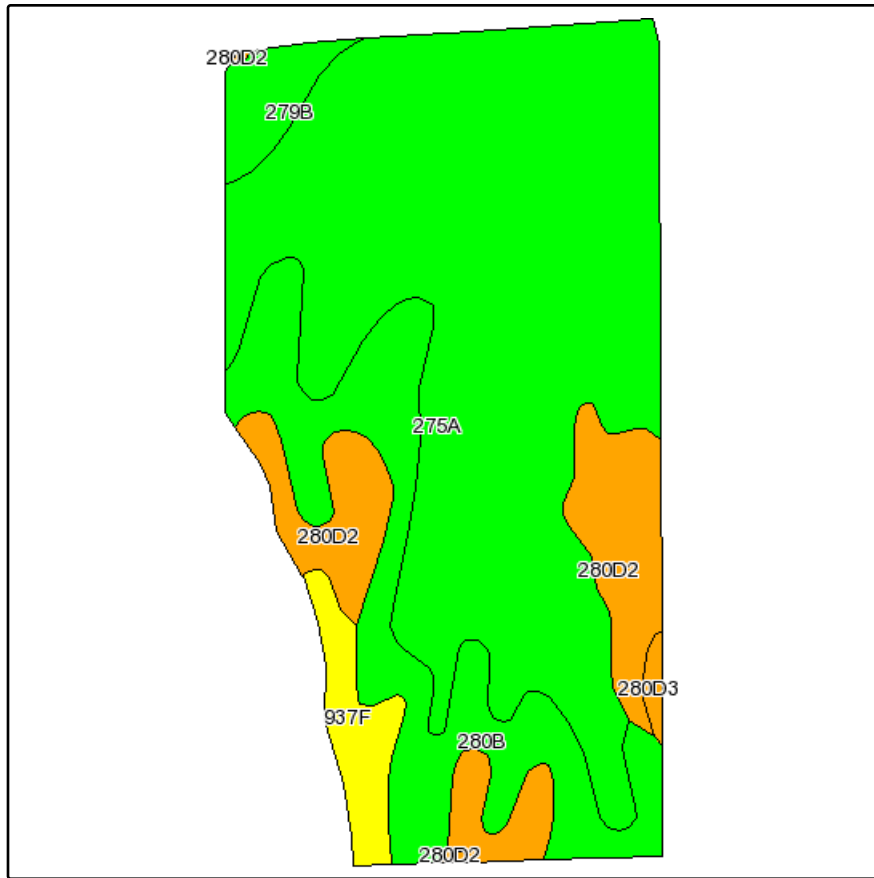
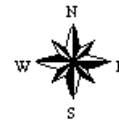

Maps provided by:



©AgriData, Inc 2008
 www.AgriDataInc.com

Fsa borders provided by the Farm Service Agency as of May 23, 2008.
 Soils data provided by USDA and NRCS.
 PLSS provided by Illinois State Geological Survey.

Code	Soil Description	Acres	Percent of field	Il. State Productivity Index Legend	Corn Bu/A	Soybeans Bu/A	Wheat Bu/A	Alfalfa d hay, T/A	Grass-legume e hay, T/A	Crop productivity index for optimum management
275A	Joy silt loam, 0 to 2 percent slopes	38.7	60.4%		178	55	68	0.00	5.42	144
**280B	Fayette silt loam, 2 to 5 percent slopes	12.4	19.5%		**149	**47	**59	**4.70	0.00	**121
**280D2	Fayette silt loam, 10 to 18 percent slopes, eroded	6.7	10.5%		**134	**42	**53	**4.23	0.00	**109
**937F	Seaton-Hickory silt loams, 18 to 35 percent slopes	2.5	3.9%		**94	**31	**37	0.00	**2.76	**77
**279B	Rozetta silt loam, 2 to 5 percent slopes	1.8	2.9%		**147	**46	**58	**4.70	0.00	**119
**280C2	Fayette silt loam, 5 to 10 percent slopes, eroded	1.5	2.4%		**140	**44	**56	**4.42	0.00	**113
**280D3	Fayette silty clay loam, 10 to 18 percent slopes, severely eroded	0.3	0.5%		**122	**38	**49	**3.85	0.00	**99
Weighted Average					162.5	50.6	62.9	1.62	3.38	131.7

Table: Optimum Crop Productivity Ratings for Illinois Soil by K.R. Olson and J.M. Lang, Office of Research, ACES, University of Illinois at Champaign-Urbana. Version: 12/21/2007 table S2rev B811

Crop yields and productivity indices for optimum management (B811) are maintained at the following NRES web site: <http://www.nres.uiuc.edu/soilproductivity>

** Indexes adjusted for slope and erosion according to Bulletin 811 Table S3

d Soils in the poorly drained group were not rated for alfalfa and are shown with a zero "0".

e Soils in the well drained group were not rated for grass-legume and are shown with a zero "0".